

Dear 2011 GSDSEF Parents and Teachers,

Registration and Judging Days are nearly here, and your GSDSEF commute will be easier by using these instructions and maps.

Part 1 of 4

Tuesday, March 22, Registration Day: 1:00 pm – 7:00 pm. Enter the Upper Parking Lot from **Inspiration Point Way** or **Presidents Way**. After parking, walk up the hill by the Veterans' Museum to the Balboa Park Activity Center. **Come early to avoid the rush hour.** If there is no parking available, please use the Balboa Park map for Sunday. **Note:** There will be limited "quick" registration parking on Inspiration Point for those who will be leaving in 15-20 minutes.

Part 2 of 4

Wednesday, March 23, Judging Day:

Wednesday Morning Drop-Off – Enter ONLY at the intersection of Inspiration Point Way and Park Blvd. Drive to the drop-off area between 7 and 7:40 am. Supervision is provided in the Exhibitors' Tent. **NO PARKING.** Exhibitors should be ready to exit the car quickly, so all 840 Exhibitors can arrive on time. Parents are welcome to sign up on the gsdsef.org web site in advance to volunteer.

EXHIBITORS' ENTRANCE - WEDNESDAY MORNING - March 23

JUDGING DAY Please bring lunch to tent

(drop off entrance for exhibitors and judges/volunteers with Special Needs parking permits)

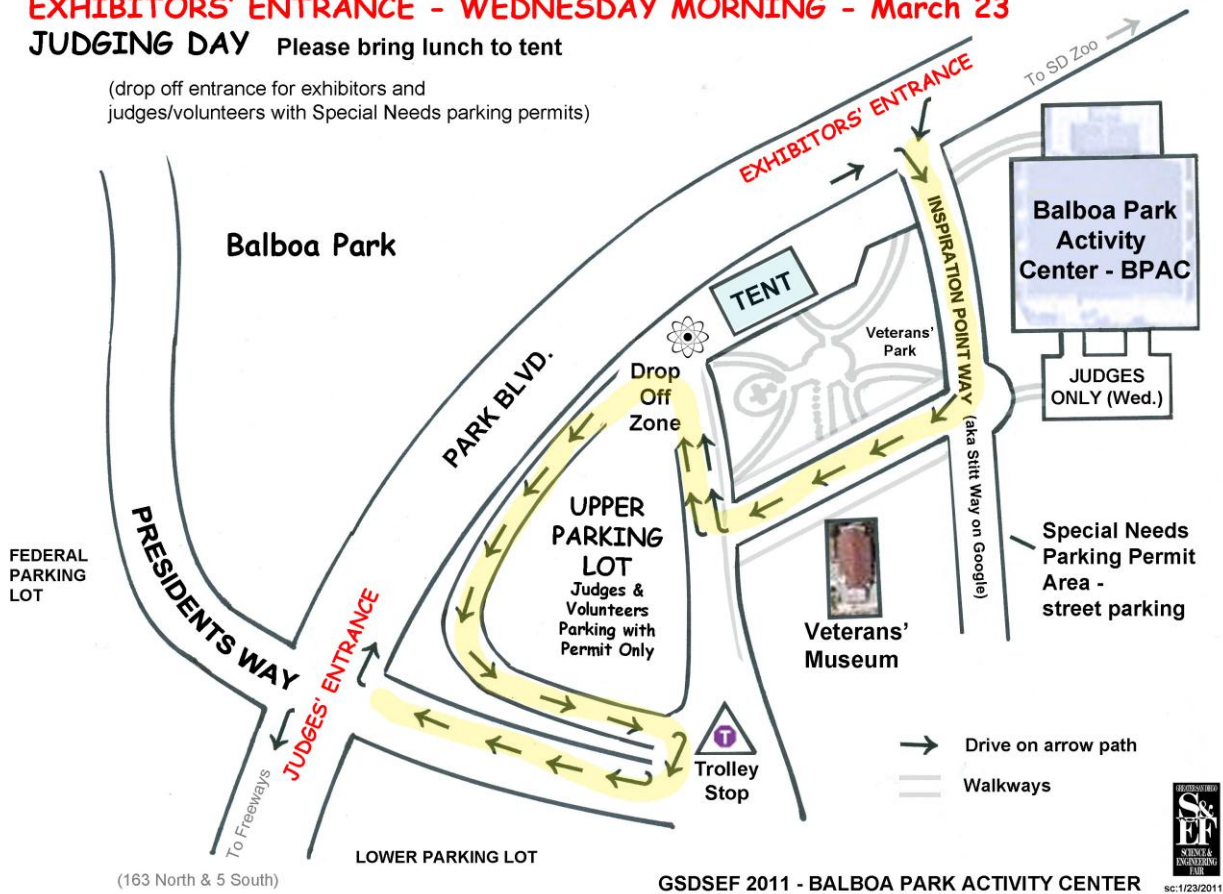

Wednesday, 3/23, Afternoon Pick-Up – Enter ONLY at the intersection of Presidents’ Way and Park Blvd. The Upper Parking Lot is closed to entry until the Exhibitors are dismissed, so drivers line up in the Lower Parking Lot to wait. Judging is generally completed by 2:45 pm. It can take until nearly 3:30 pm for cars to leave the parking lot, so make plans with this delay in mind. As soon as the Exhibitors are dismissed, the cars are let into the Upper Parking lot. Continue driving carefully around the lot until you pick up your Exhibitor(s), and then exit the parking lot. Police Officers will provide traffic control, so if you are walking please do not cross the street when cars can proceed.

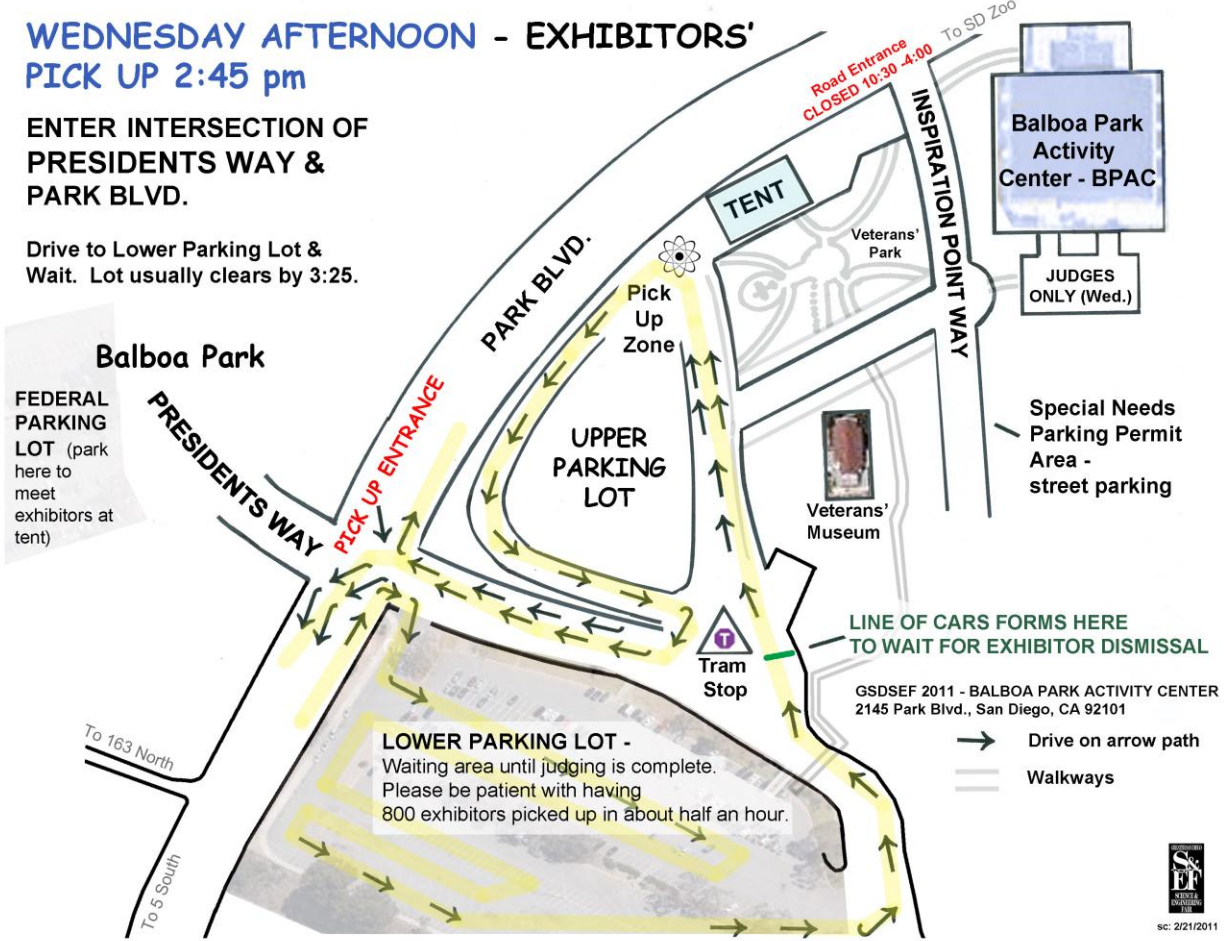

Note: Please walk and drive with care so Exhibitors and others are safe. Avoid walking in Upper Parking Lot.

Part 4 of 4 **2009** **2009** **2009** **2009** **2009** **2009** **2009**

Sunday, March 27, Project Pick-up 3:00 – 4:00 pm.

It's Family Day at the Science Fair, so come early to enjoy the projects and programs. Balboa Park rarely has parking available on Sundays, so the following map shows other parking lots, if the

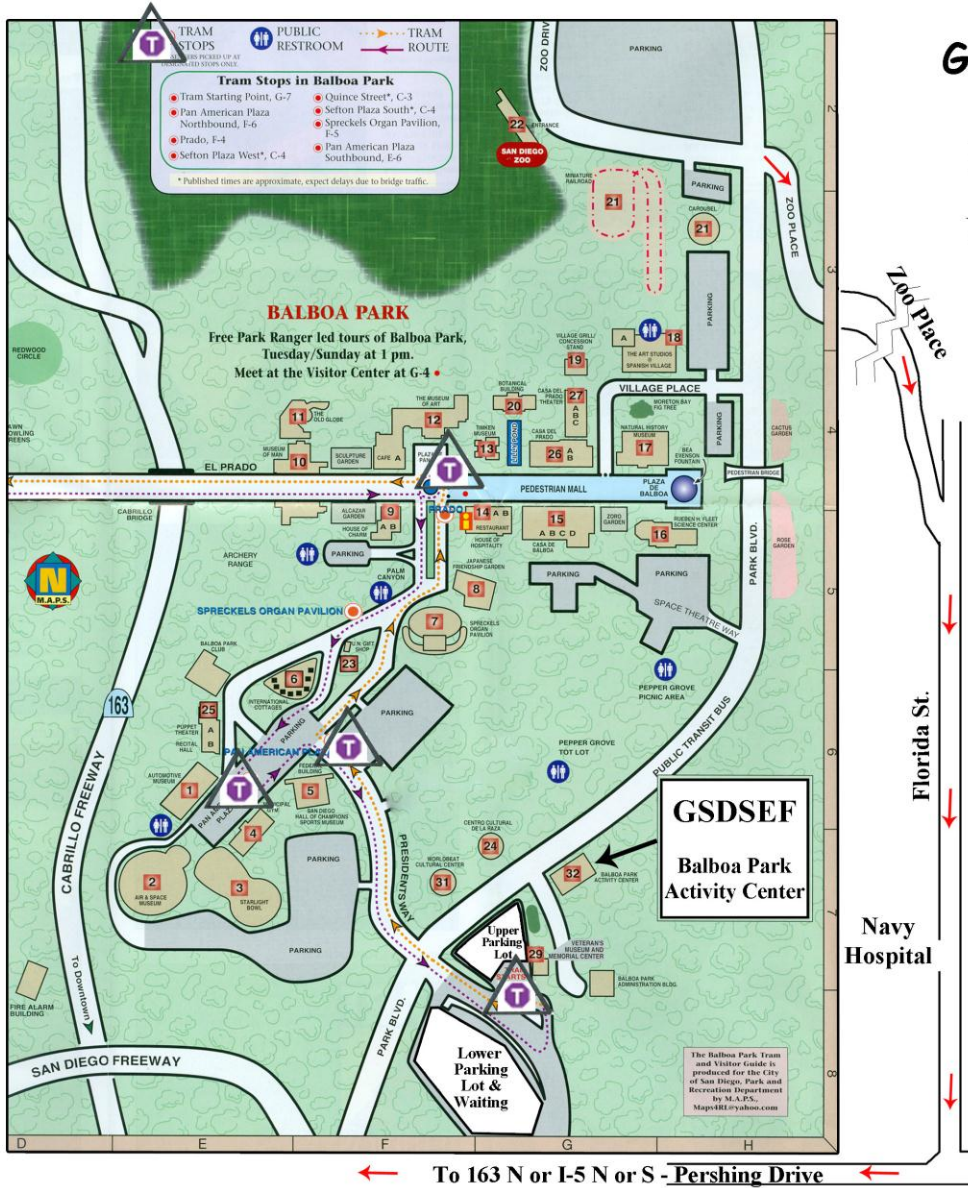

GSDSEF - Other Parking When Upper & Lower Parking Lots are FULL

Use the Tram,  when parking or visiting Museums free with Exhibitor badge.

Note: When leaving on Judging Day or Project Pickup on Sunday, the left turn onto Park Blvd. often backs up. EZ Exit turn right & follow red arrows on this map:



Upper and Lower Parking Lots are full.

P.S. Car Pools are encouraged on all days!